



June Tailor, Inc.

# Custom Cornice Window Treatment Installation Instructions

## Outside Mount Cornice:

### *(Single Piece Mounting Bracket)*

Count the number of metal mounting brackets included with your cornice. Mark placement of brackets on wall above window frame to evenly distribute the number of brackets across the space. Your cornice has multiple channel units or a single channel running the entire width of the cornice. If your cornice has multiple units, hold cornice up to markings or measure to ensure the brackets will align with the channel units. Using anchors and screws, attach metal brackets to wall.

Hold the cornice up, centering on window. Pull the cornice down, placing lip of hanger channel(s) over mounting brackets. The cornice may be accurately centered on your window by carefully sliding to the left or right.

## 2 Piece Mounting Brackets:

Using short screws provided in your hardware kit, attach bottom bracket with slide bar opening to top bracket with single hole. Adjust to appropriate depth and tighten screw.

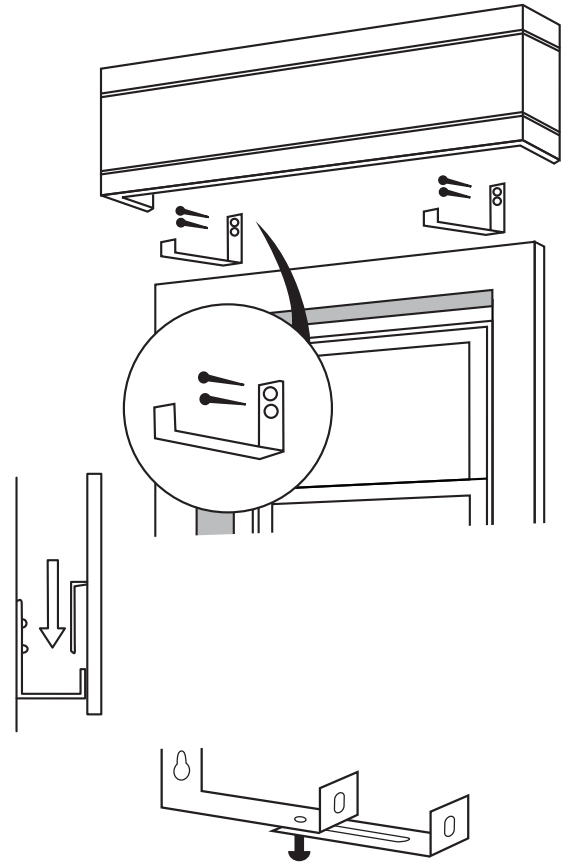

## Inside Mount Cornice:

Count the number of metal mounting brackets included with your cornice. Mark placement of brackets one inch deep in casing, evenly distributing brackets across width of space. Your cornice has multiple channel units or a single channel running the entire width of the cornice. If your cornice has multiple units, hold cornice up to markings or measure to ensure the brackets will align with the channel units. Mark and pre-drill holes. Pre-mount brackets leaving screws out approximately 1/4 inch. Remove brackets leaving screws in place.

Attach brackets to back of cornice, placing lip of hanger channel over mounting brackets. Align brackets with screws by sliding brackets back and forth within channel. Place brackets with cornice over screws and slide back in screw slots. Tighten screws to secure cornice in place.

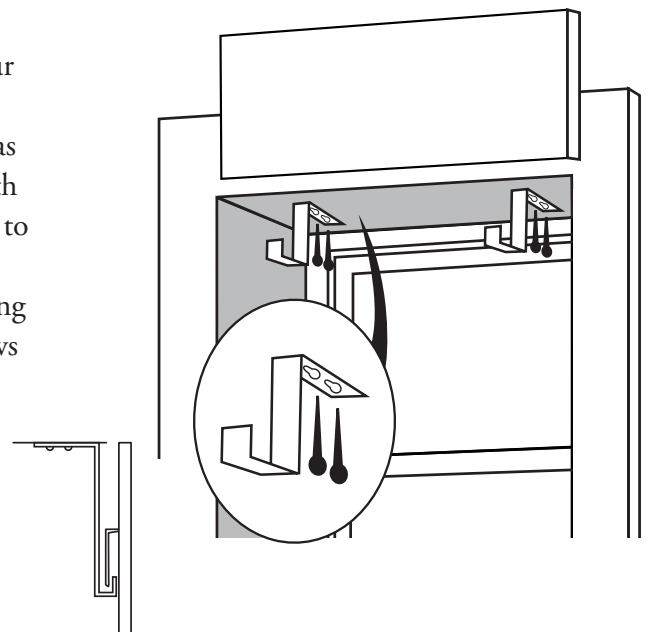

June Tailor, Inc.

P.O. Box 208, 2861 Highway 175, Richfield, WI 53076 • Phone: 1-800-844-5400 • Fax: 1-262-644-5061